

Features 1

- Meet DMX512 (1990) international standard protocol
- Control 4 zones brightness or color temperature separately or synchronously
- 3 customize scenes can be saved
- Each channel can achieve 256 levels brightness adjustment
- High sensitive & high stable Glass touch, fast & precise control
- Interface using tempered glass material, stylish appearance



Technical parameters 2

Voltage: 5VDC

Dimming: DMX512

Power : 3.5W

Pack size: 145(L)*135(W)*48(H) mm

Channels: 8

Product size: 86(L) *86 (W)*10 (H) mm

Indicator light: 9

N.G: 110g

Zones: 4

Work temperature: 0℃ - 50℃

Scenes: 3

Dimension 3

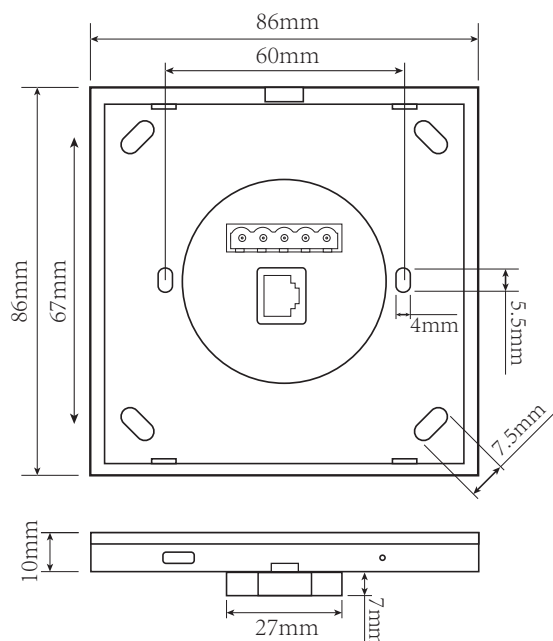

Appearance 4

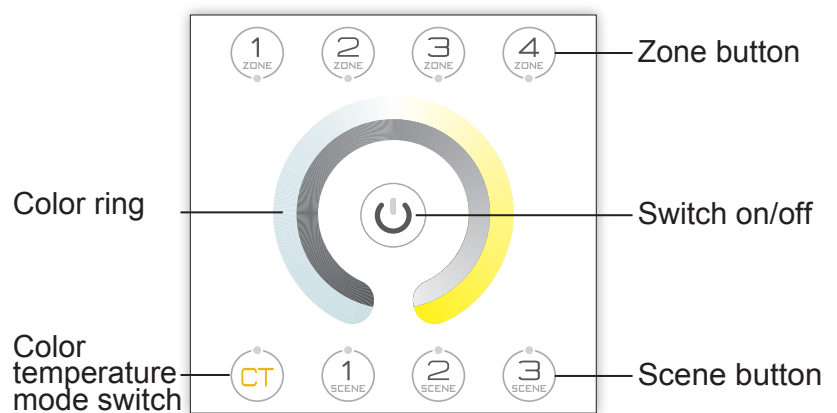

Operation Guide 5

ON/OFF

Under OFF state, click on the “on/off” button to open DMX panel, the lamps controlled by the panel will light up with the last closed state. Under ON state, click on the “on/off” button, you can close the panel, all lamps controlled by this pannel will turn off. on/off led indicator will light weakly, indicate the on/off switch position in darkness.

Area/Zone Dimming

The panel supports four DMX zones, each zone has 2 channels. That zone 1 for channel 1~2, zone 2 for channel 3~4, zone 3 for channel 5~6, zone 4 for channel 7~8. Each zone has a corresponding indicator.

Click Zone1/2/3/4 button can be individually selected corresponding zone, the lamps connected of the zone will light up with the brightness or color temperature saved last, and the corresponding indicator will light, so lamps of the zone can be adjusted color temperature or brightness. Through selecting "Color ring" or "Color temperature mode" button to editing lighting effects. Other zones will stay the same.

Click another zone button to switch zone, the lighting effects of other zones will not change. Only the zone led indicator light up, indicated the zone could be adjusted.

When one zone is selected, click on the zone button again, can close the zone lamps, while the zone led indicator will off.

Long press one zone button 2 seconds, the four zones selected simultaneously, four zone led indicators light up, in this case you can operate four zones synchronously.

Scene Settings

Click on Scene1/2/3 button, you can play 3 kinds of scene saved by user. Each time can play one scene. In the scene play mode, you can't adjust color temperature/brightness of lamps.

After adjust the brightness or color temperature of lamps on one or multiple zones, then long press the scene button for 3 seconds, After "di-di-di" Tone, means the lighting effects of four zones have been saved in this scene successfully.

You can save up to three scenes user-defined. You can continue to save a new scene effect on the scene button that has saved scene (Note: The scene saved before will be covered).

Lighting Effects Editor

When you need to edit the lamps of brightness or color temperature, you can use the panel powerful live editing function of panel. Notice: You can edit lighting effects only after the corresponding zone have selected. Please refer to "Area/Zone Dimming" instruction to select the zone.

CT: Switch color temperature or brightness mode. When CT indicator light up, there is color temperature mode; When CT indicator not light, there is brightness mode.

Color Temperature Mode

When in CT mode, touch the color ring to adjust warm color and cool color of lamps. Lighting model as follows:

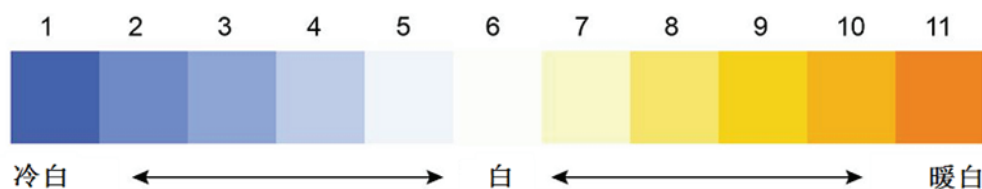

Dimming/Brightness mode

When in dimming mode, touch the color ring to adjust the brightness of lamps. When touch the color ring clockwise, the brightness of the lamp gradually increase; while touch the color ring anticlockwise, the brightness of the lamps decrease gradually.

Button Tone Settings

Use the DIP switch1 to set button tone. When set the DIP switch 1 to "ON" , the button tone is enable; Otherwise, the button tone is disable.

Button Indicator Settings

Use the DIP switch 2 to set the button indicator light. When set the DIP switch on "ON" , the button indicator will light up when touch the button; Otherwise, the button lights are disabled.

Interface Introduction

6

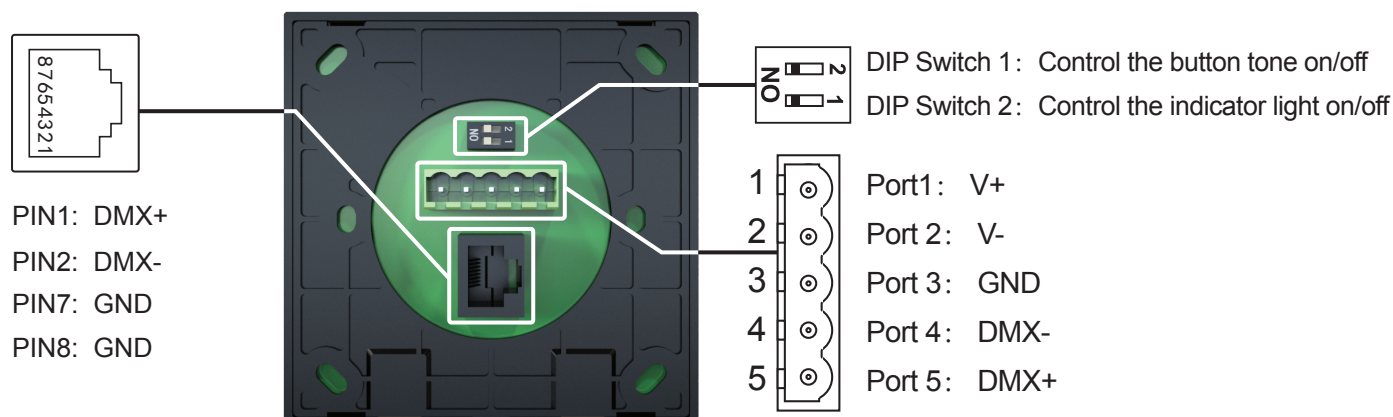

Notice: USB port and RST port is reserved, don't use in this product.

DMX Diagram

7

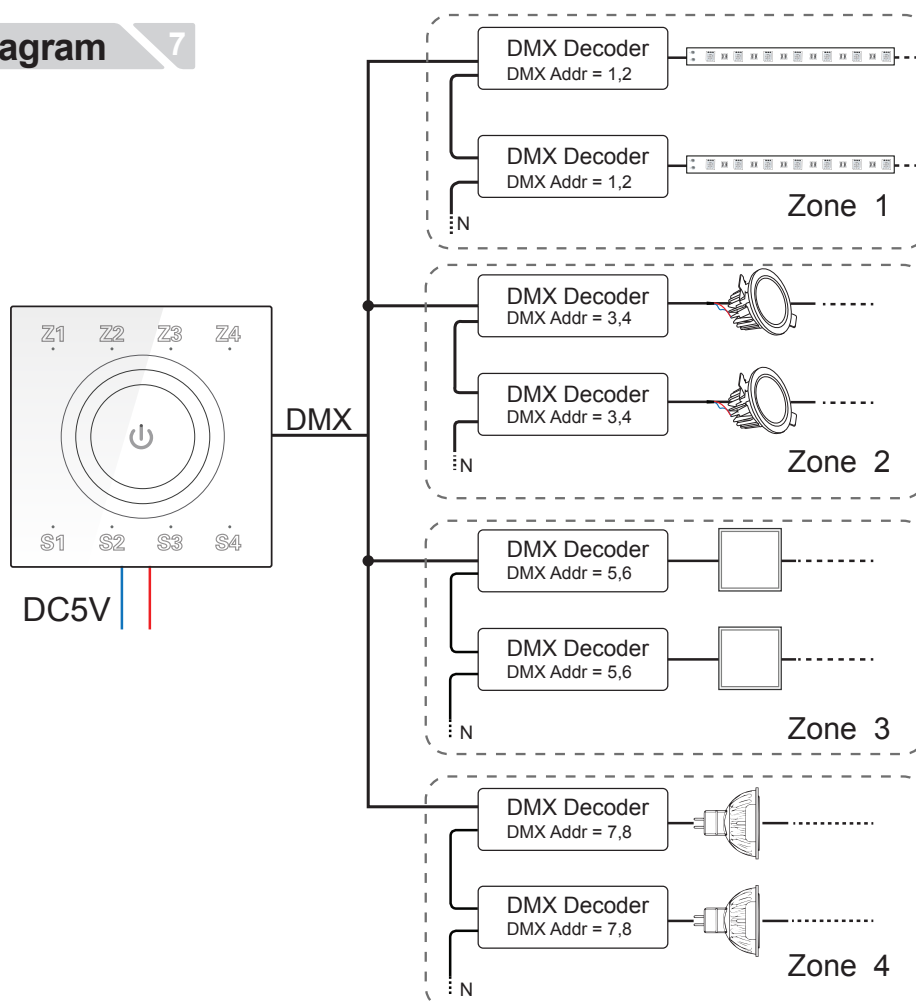

Installation guide

8

1. Mount an electrical box inside the wall

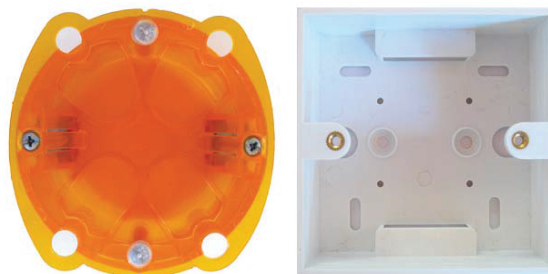

2. To separate the glass panel and the back cover of the controller with a screwdriver along the gap of the back cover.

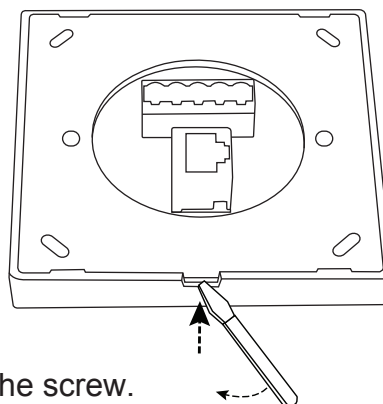

3. put the back cover on the electrical box and fix it with the screw.

4. Connect the wires

DMX: Connect the DMX cable to the DMX interface

Power: Make sure to not invert the + and the ground

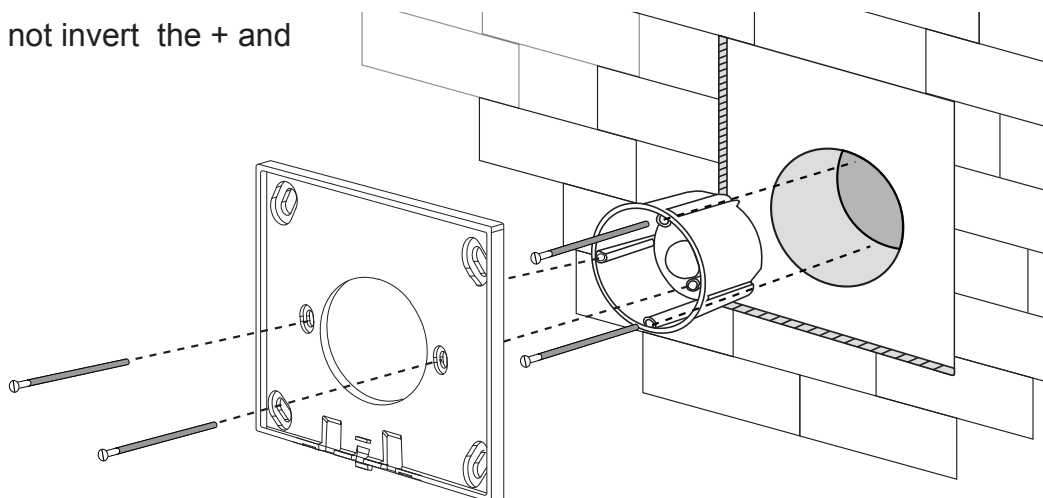

5. To buckle the glass panel to the back cover.

